

# Oil Mist Eliminator

## Applications:

Oil Mist Eliminators(OME) are used to separate and trap oil mist and odours Discharged with the exhaust from oil sealed rotary vacuum pumps as required by COSHH and Health and Safety regulations

When vacuum pumps are started they usually emit a considerable quantity of oil vapour into the air. The oil mist contains oil and also contaminants which are in the pump. Oil mist accumulated on any surface within close proximity to the pump creating potential environmental and health hazards.

The OME incorporates a PSI Global separator, using patented ARTm™ and NoDL™ technologies,that allows the pump to exhaust whilst trapping oil droplets which then condense and can be returned to the pump. An optional pressure relief valve bypasses the filter in the event of a blockage. We also offer an activated carbon AC filter element which will neutralize the smell of oil mist.



## Benefits

- Eliminates oil fumes
- Prevents loss of pump oil
- Returns used oil to pump if oil return kit added
- Standard NW outlet and inlet flange fitting
- Long lasting patented PSI Global separator
- Optional pressure relief valve
- Optional activated carbon filter element

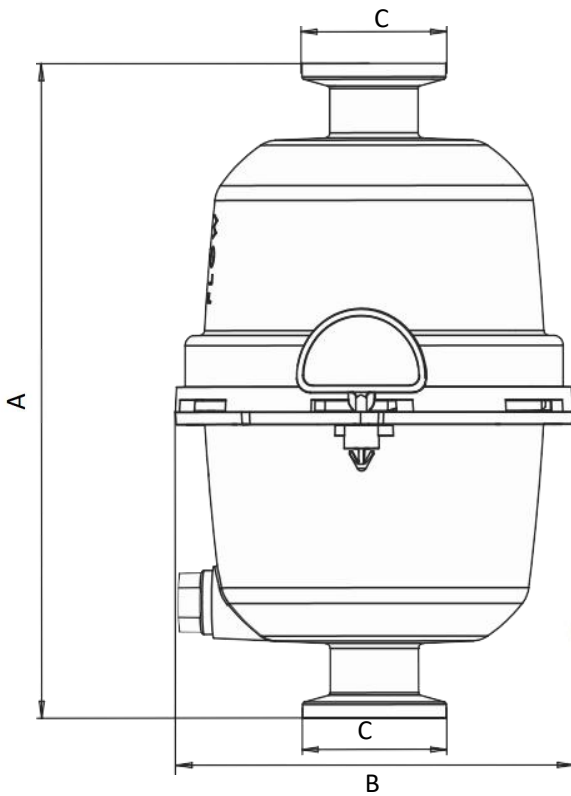

## Technical data

- Ambient Operating Temperature: 0-45°
- Ambient Storage Temperature: 10-90°C
- Maximum back pressure: 12 psig (1.8 bar absolute, 1.8 x 10<sup>5</sup> Pa)
- Relief pressure: 20 psig (2.37 bar absolute, 2.37 x 10<sup>5</sup> Pa)
- Mist filter separator: ARTm™ and NoDL™ patented technology
- AC filter element: Activated carbon
- OEM body material: Crystalline nylon

## Products Code:

Dimensions (mm)	Oil Mist Eliminators		
	OME01-010 Type	OME01-016 Type	OME02-025 Type
A	128	128	171
B	82	82	98
C	NW10	NW16	NW25
Rated Flow	3m <sup>3</sup> h <sup>-1</sup>	3m <sup>3</sup> h <sup>-1</sup>	12m <sup>3</sup> h <sup>-1</sup>
W/ Relief valve&carbon filter element	OME01-010 PRV PC	OME01-016 PRV PC	OME02-025 PRV PC
W/ Relief valve	OME01-010 PRV	OME01-016 PRV	OME02-025 PRV